



Gauges

Type	PPG-20	PPG-40	PPG-50
Scale	MPa	MPa / PSI	MPa / PSI
Dimension [mm]	□ 27	∅ 40	∅ 50
Accuracy	±4% F.S.	ASME B class	
Max. pressure	The max. scale of gauge times 1,2		
Temperature range [°C]	-5 to +60		
Weight [kg]	0,011	0,054	0,108

Suitable for series	PPG-20	PPG-40	PPG-50
MAR200	×	✓	×
MACP302, MAR302, MAFR302	✓	✓ + PA-MAR302*	×
MACP401, MAR401, MAFR401	✓	✓ + PA-MAR401*	×
MACP501, MAR501, MAFR501	✓	✓ + PA-MAR302*	×

\*) Note for series 302, 401 and 501: Gauge with a thread can only be used with a threaded adapter, order code PA-MAR302 (for series 302 and 501) or order code PA-MAR401 (for series 401). See below.

Order codes

PPG – 20W

Color, for series	Range
black, series 401	0 to 1,0 MPa
W white, series 302, 501	0 to 1,0 MPa

PPG-20

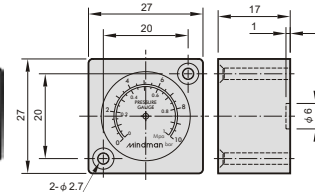

PPG – 40S – 5K

Color, material	Range
black, standard	0 to 1,0 MPa, standard
S stainless steel	-1K 0 to 0,1 MPa
	-3K 0 to 0,3 MPa
	-5K 0 to 0,5 MPa
	-20K 0 to 2,0 MPa

PPG-40

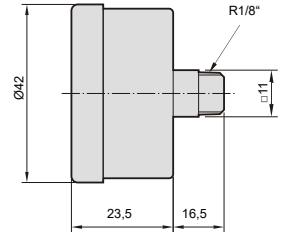

PPG – 50 – 20K

Range
0 to 1,0 MPa, standard
-20K 0 to 2,0 MPa

PPG-50

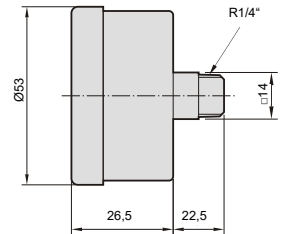

8

Threaded adapter (for mounting a threaded gauge instead of a built-in square gauge)

Description	Order code
Threaded adapter for series MAX302 and MAX501	PA-MAR302
Threaded adapter for series MAX401	PA-MAR401

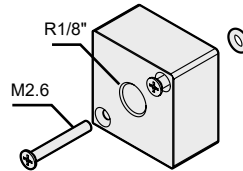

Recommended tightening torque is between 1,5 to 2,5 Nm for the female thread (1/8") and 0,3 to 0,5Nm for the screws (M2.6).

Gauges for panel mounting

Order codes	D - diam.	Thread	Range [bar]	A	B	C	E	OK
2980 0000 0600 0003	50	G1/4"	0 to 10	52,5	32,5	5,3	55	14
2980 0000 0600 0004	50	G1/4"	0 to 16	52,5	32,5	5,3	55	14
2980 0000 0600 0005	63	G1/4"	0 to 10	51,5	31,7	5	68	14
2980 0000 0600 0006	63	G1/4"	0 to 16	51,5	31,7	5	68	14

