

HEAVY HORIZONTAL TOGGLE PNEUMATIC CLAMPS



STRÁNSKÝ A PETRŽÍK



A range of clamps for heavy-duty applications with long service life, equipped with a horizontally mounted pneumatic cylinder. Pneumatic toggle clamps are particularly suitable for clamping components during welding, in the automotive industry, or wherever a high clamping force is required. Once clamped, the mechanism provides self-locking security, preventing release in the event of compressed air failure. They are fitted with a double-acting pneumatic cylinder with a magnetic piston for non-contact position sensing.

Working pressure	0,6 MPa
Min. pressure	0,15 MPa
Max. pressure	1,0 MPa
Temp. range	-30°C to +80°C
Working medium	modified compressed air

2

Piston diameter [mm]	63
Connections	G1/4"
Release angle [°]	90
Pneumatic cylinder stroke [mm]	120
Clamping force F2 at pressure 0,6 MPa [N]	4.000
Locking force F1 at clamped position [N]	20.000
Weight [kg]	18,30

Order codes

2000 10257 063 0120

Piston diameter		Stroke / angle	
063	63 mm	0120	120 mm, release angle 90°



In case of proximity sensing request, please use switches series KT-21 or RZT7/MZT8 - see page 3-2 and 3-4 for details (cylinder with profile VDMA 24562).



Caution

The clamp must be correctly adjusted in its working (clamped) position, to be self-locking.

Dimensions

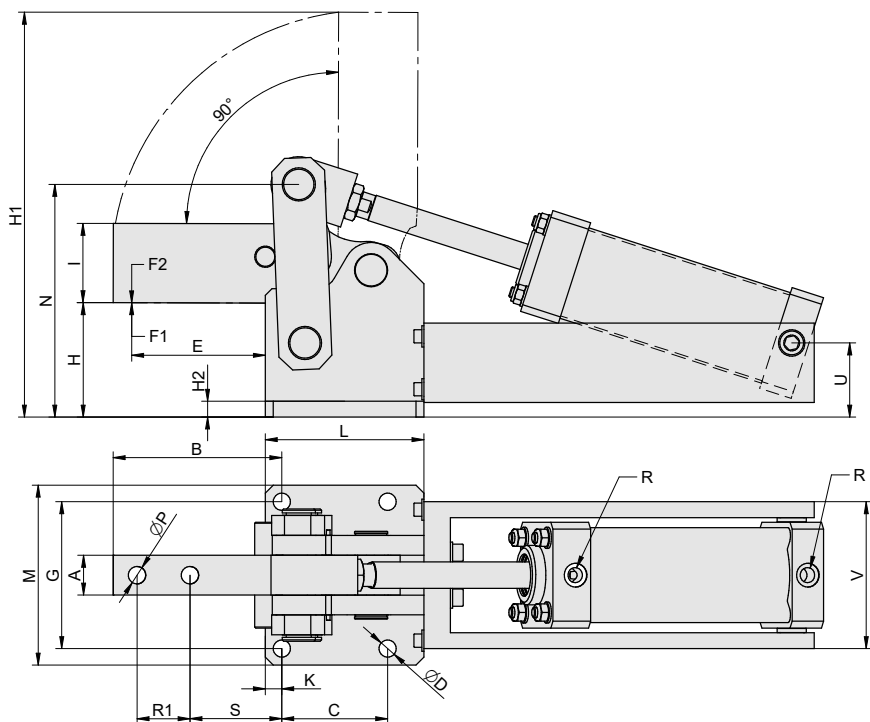

∅	A	B	C	D	E	G
63	30	128	80	13	114,5	111

∅	H	H1	H2	I	K	L
63	86	310	12	60	12,5	120

∅	M	N	P	R	R1	S
63	135	176	13,2	G1/4"	40	69,5

∅	U	V
63	56	111

Construction / materials

- body, end cap: dural, anodized
- piston rod: CK45
- arm and cosnole: steel, zinc plated
- clamping arm support: slide bearing