

# DOUBLE ACTING PNEUMATIC CYLINDERS DIN ISO 6431, VDMA 24562 WITH PLASTIC END CAPS



The dimensions of these cylinders comply with the international standards ISO 6431, VDMA 24562 and NF E 49003.1 and are therefore easily interchangeable. The cylinders can have adjustable cushioning at end positions and are equipped with a magnet in the piston for the possibility of sensing end positions. The smooth design facilitates rinsing of dirt, the construction minimizes gaps and places with poor accessibility for cleaning the cylinder surface. The end caps are made of plastics that are chemically resistant to mild alkalis and acids used in cleaning equipment in the food industry. This type of cylinder is not a replacement for a stainless steel cylinder, but it is an affordable alternative.



Working pressure	0,6 MPa
Min. pressure	0,15 MPa
Max. pressure	1,0 MPa
Temp. range	-30°C to +60°C *
Working medium	modified compressed air

\*) values are valid for standard gaskets

Piston diameter [mm]	32	40	50	63	80	100	125	160	200
Thrust at 0,6 MPa [N]	482	754	1178	1870	3015	4713	7363	12064	18849
Thrust at 0,6 MPa [N] with double ended piston rod	415	633	990	1682	2720	4418	6880	11581	18096
Return force at 0,6 MPa [N]	415	633	990	1682	2720	4418	6880	11581	18096
Connection	G1/8"	G1/4"	G1/4"	G3/8"	G3/8"	G1/2"	G1/2"	G3/4"	G3/4"
Length of adjustable cushioning [mm]	13	13	11	16	16	20	25	27	32
Max. stroke [mm] *	1000*	1000*	1000*	1000*	1500*	1500*	2000*	2000*	2000*
Weight 0 mm stroke [kg]	0,37	0,55	0,81	1,21	1,97	3,40	6,50	11,20	18,00
Weight add. per 1 mm stroke [kg]	0,0028	0,0037	0,0060	0,0062	0,0100	0,0110	0,0160	0,0280	0,0300
Weight 0 mm stroke [kg] with double ended piston rod	0,46	0,65	1,00	1,39	2,60	4,15	8,20	14,10	19,50
Weight add. per 1 mm stroke [kg] with double ended piston rod	0,0038	0,0047	0,0080	0,0082	0,0140	0,0150	0,0220	0,0400	0,0420

\*) Stroke of cylinder may be longer after agreement with our technical dept.

## Order codes

10301 60 00 050 0100

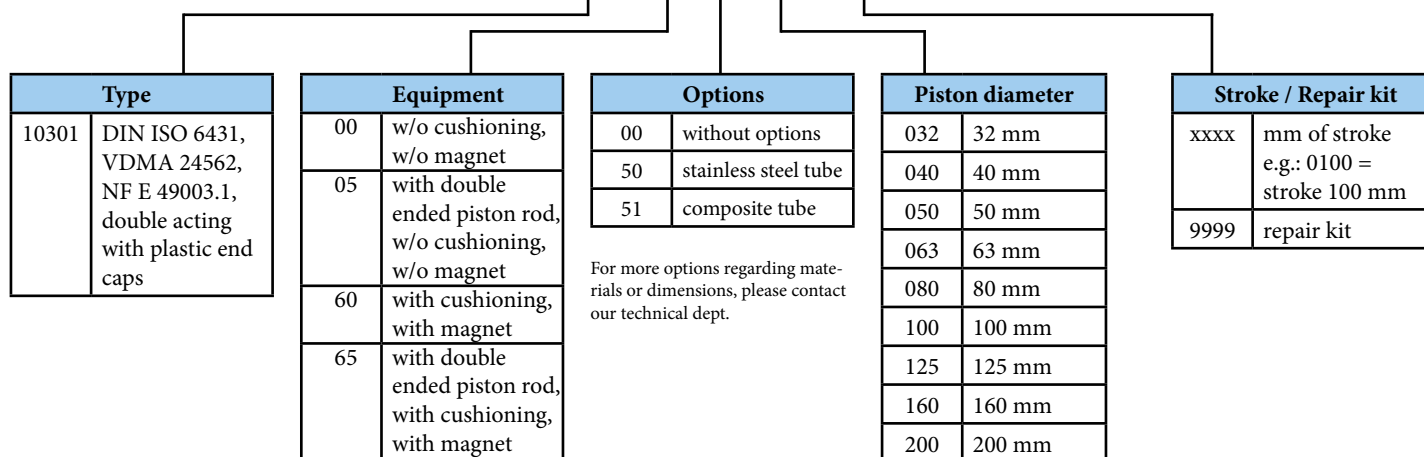

## Construction / materials

- caps: POM plastic
- body: drawn aluminium tube, anodized
- piston rod: ground stainless steel rod 1.4301, surface chrome-plated
- piston rod seal: E8 (PEE+NBR)
- other seals: NBR or PU
- steel parts: stainless steel 1.4301



The plastic material of the end caps has significantly better resistance than most Al alloys, and is cheaper than stainless steel materials. The cylinders are suitable for environments with moderate exposure to chemically aggressive substances, which some Al alloys cannot withstand.

**Dimensions**

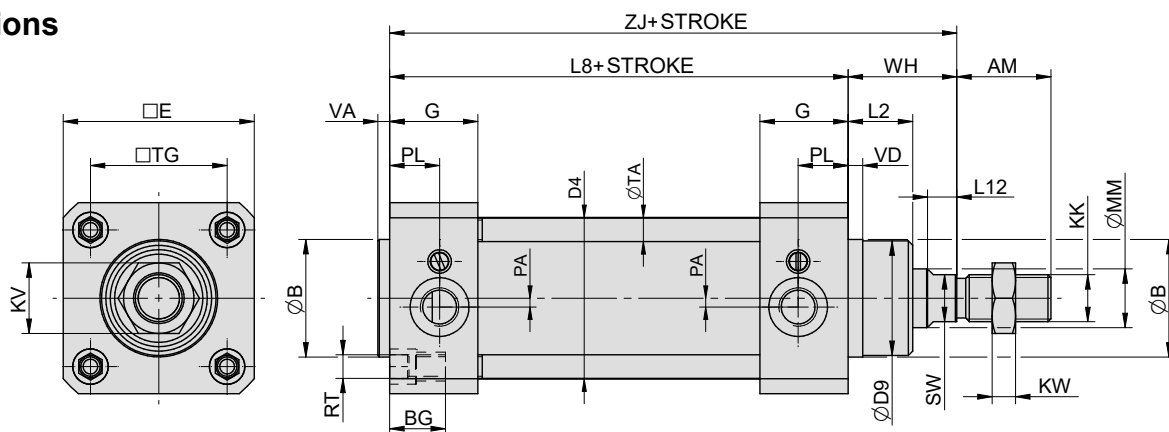

Double ended piston rod:  
other dimensions are the  
same as standard type)

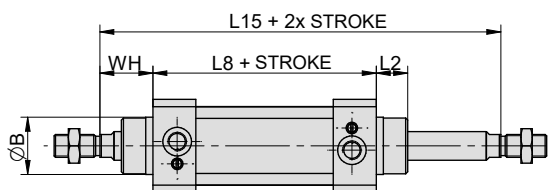

Ø	AM	B	BG	D4	D9	E	EE	G	KK	KV	KW	L2	L8	L12	L15	MM	PA	PL	RT	SW	TA	TG	VA	VD	WH	ZJ
32	22	30	16	36	28	48	G1/8"	31,5	M10x1,25	17	6	18	94	8	146	12	5	22,5	M6	10	5,25	32,5	4	4	26	120
40	24	35	16	45	34	55	G1/4"	32	M12x1,25	19	10	20	105	9	165	16	5	20	M6	13	5,25	38	4	4	30	135
50	32	40	19	55	39	65	G1/4"	30	M16x1,5	24	8	22	106	10	180	20	3	17	M8	16	7,1	46,5	4	5	37	143
63	32	45	19	68	44	75	G3/8"	30	M16x1,5	24	8	23	121	10	195	20	6	16	M8	16	7,1	56,5	4	5	37	158
80	40	45	19	86	44	94	G3/8"	30	M20x1,5	30	9	31	128	10	220	25	10	16	M10	21	8,85	72	4	5	46	174
100	40	55	19	106	54	115	G1/2"	36	M20x1,5	30	9	34	138	10	240	25	11	18	M10	21	8,85	89	4	17	51	189
125	54	60	20	132	58	140	G1/2"	40	M27x2	41	12	50	160	14	290	32	11	22	M12	27	10,7	110	6	6	65	225
160	72	65	24	168	64	185	G3/4"	50	M36x2	55	18	50	180	20	340	40	10	25	M16	36	16	140	6	10	80	260
200	72	75	24	212	74	235	G3/4"	50	M36x2	55	18	55	180	20	370	40	12	25	M16	36	16	175	6	20	95	275

**Mounting accessories  
(stainless steel)**

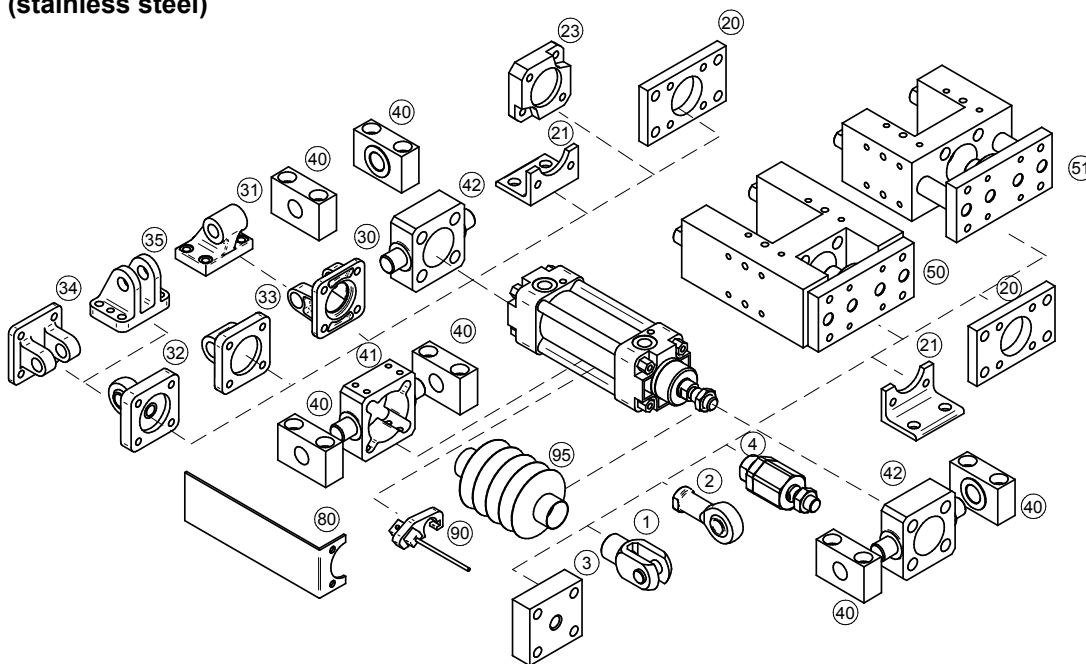

Mounting accessories	... see page
1 Piston rod clevis	... 4-27
2 Piston rod eye	... 4-27
3 Flanged piston rod coupl.	☺
4 Self-align. piston rod coupl.	☺
20 Flange mounting	☺
21 Foot mounting	☺
23 Boxer flange mounting	☺
30 Swivel flange	☺
31 Clevis foot mounting	☺
32 Swivel flange with spherical bearing	☺
33 Swivel flange	☺
34 Narrow swivel flange	☺
35 Rectangular swivel flange	☺
40 Trunnion mounting	☺
41 Pivot pin	☺
42 Pivot pin to front/end cap	☺
50 Guide unit H with ball bearings	☺
51 Guide unit with slide bearings	☺
80 Valve bracket	☺
90 Prox. switch	... 3-2, 3-4, 3-7
95 Piston rod protective cover	... 4-4